



# Glazed Steel Single Door w/ Sidelites

CONTINUOUS HEAD & SILL FRAME SYSTEM  
INSWING / OUTSWING  
"NON-IMPACT"

**EVALUATED FOR USE IN THE STATE OF TEXAS**

The Glazed Steel Door system described herein complies with the 2018 International Residential Code (IRC), Sections R301 & R609 and the 2018 International Building Code (IBC), Sections 1404.13, 1609, 1709.5, 2403 and 2404 subject to the following conditions:

1. Anchors shall be as listed and spaced as shown in the details. Anchor embedment to base material shall be beyond wall dressing or stucco.
2. When used in areas requiring wind-borne debris protection this product is required to be protected with an impact resistant covering that complies with Section R301.2.1.2 of the IRC and Section 1609.2 of the IBC.
3. Allowable design pressure requirements must be equal to or less than the design pressure rating shown in the design pressure chart, sheet 1 of this drawing.
4. Conditions not covered by this drawing are subject to further engineering analysis.

TABLE OF CONTENTS	
SHEET #	DESCRIPTION
1	Typical elevations, design pressures & general notes
2	Door panel details
3	Slidelite panel details
4	Horizontal cross sections
5	Vertical & horizontal cross sections
6	Vertical cross sections
7	Frame anchoring

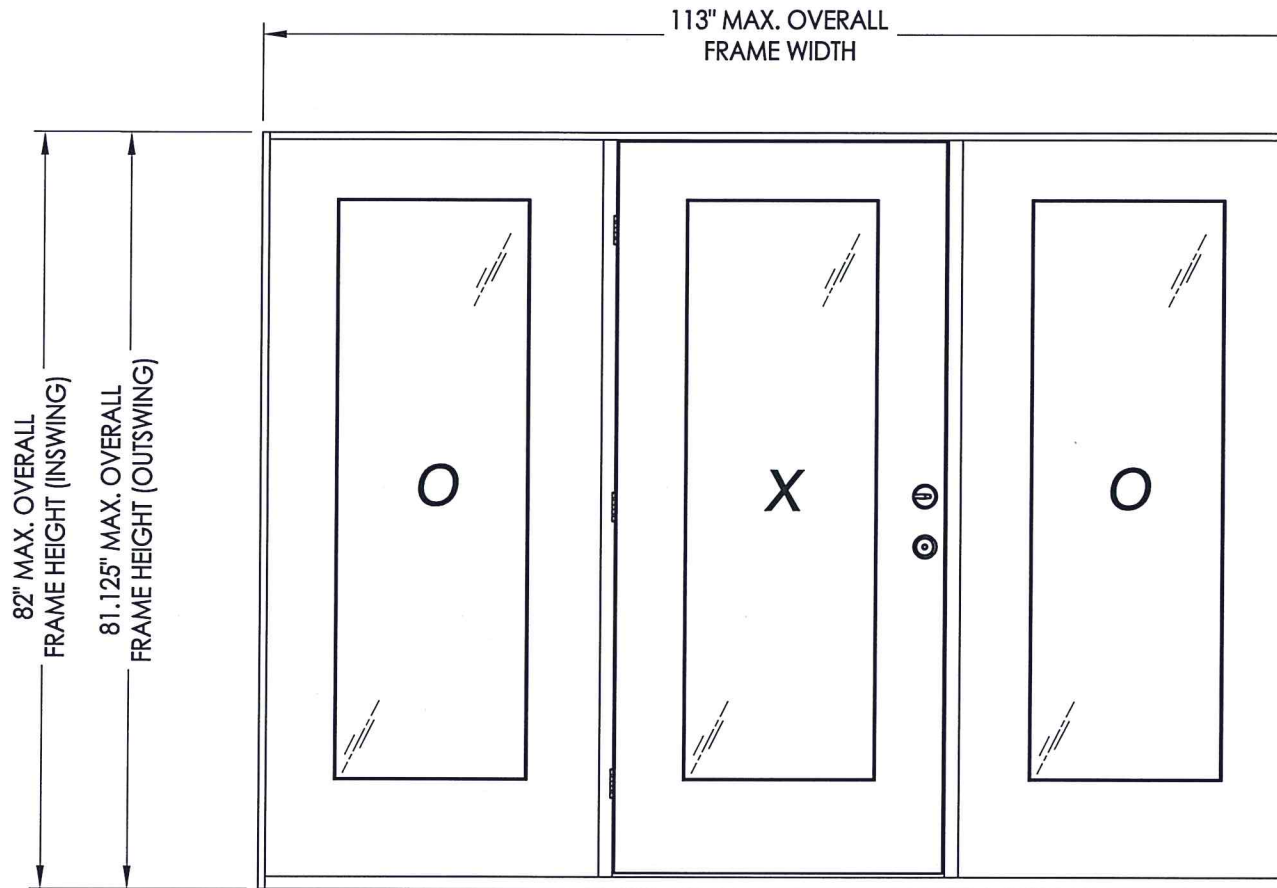

MODEL	DESIGN PRESSURE (PSF) w/ PINE FRAME & FATBOY PINE MULLIONS		DESIGN PRESSURE (PSF) w/ "FusionFrame" FRAME & MULLIONS	
	POSITIVE	NEGATIVE	POSITIVE	NEGATIVE
INSWING	+50.0	-55.0	+50.0	-50.0
OUTSWING	+50.0	-50.0	+50.0	-50.0

SEE SHEET 6 FOR THRESHOLD DESIGN PRESSURE LIMITATIONS

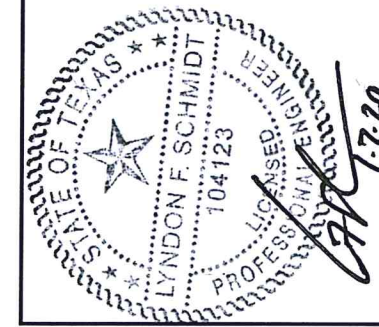

Documents Prepared By: Lyndon F. Schmidt, P.E.  
TEXAS P.E. #104123

**RW** BUILDING CONSULTANTS, INC.  
P.O. Box 230 Valrico FL 33595  
Phone No.: 813.659.9197  
TEXAS BOARD OF PROFESSIONAL ENGINEERS  
CERTIFICATE OF REGISTRATION # F-11852

PRODUCT:	ENDURA	
PART OR ASSEMBLY:	TYPICAL ELEVATION, DESIGN PRESSURES & GENERAL NOTES	
NO.	DATE	BY
1	1/06/20	LFS
ADD "FusionFrame" OPTION & UPDATE TO 2018 IBC/IRC CODE		
REVISIONS		
DATE:	12/11/17	
SCALE:	N.T.S.	
DWG. BY:	JK	
CHK. BY:	LFS	
DRAWING NO.:	TX-4775	
SHEET	1	OF 7



R:\Clients\Endura PERMANENT\B - Texas Dept of Ins\TDI - DR-957 Glazed Thermo-Tru FG door OXO (L,K, DB) 36 in SL (4775-4776)\C - Drawings\TX-4775.76.dwg, 2.3

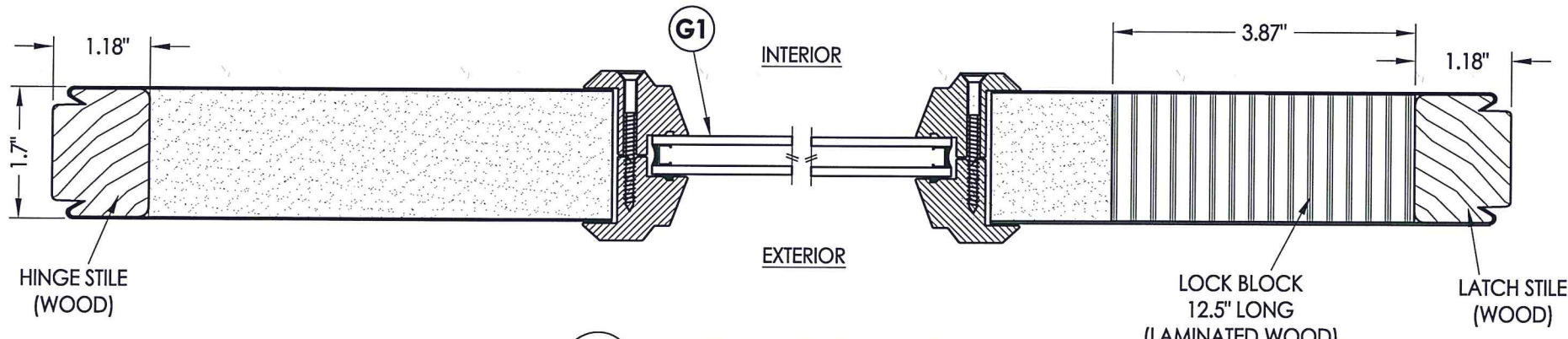

1 HORIZONTAL CROSS SECTION

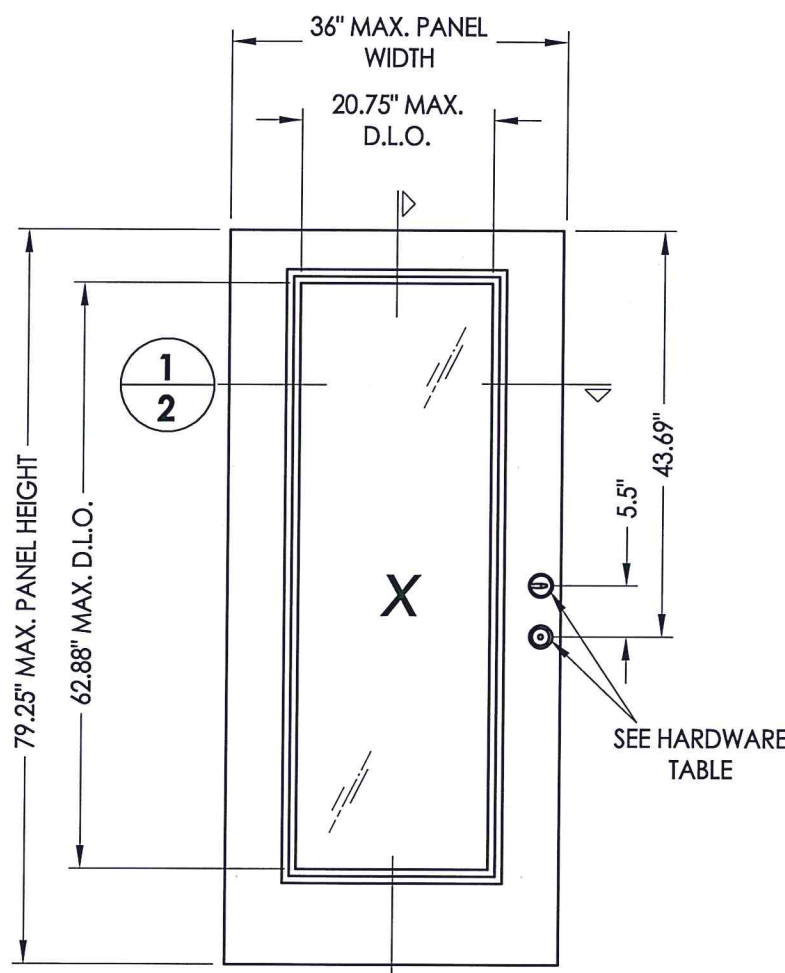

40 DOOR PANEL  
Therma-Tru Steel (Wood Edge)

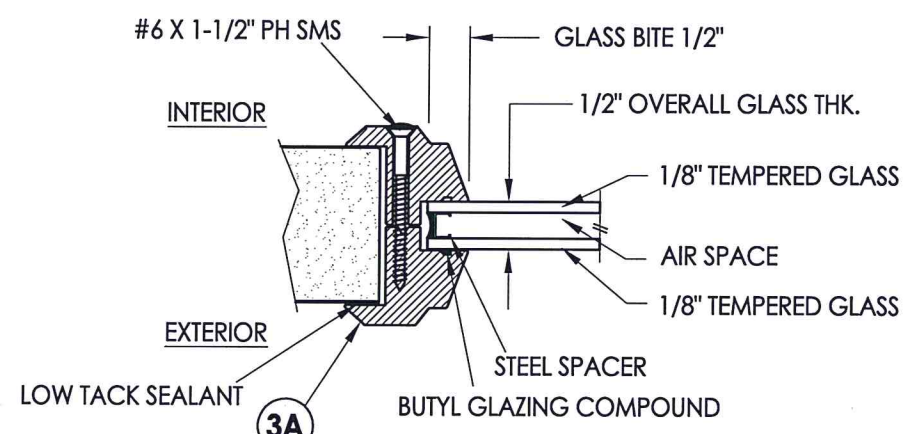

G1 GLAZING DETAIL  
PVC Lite Frame

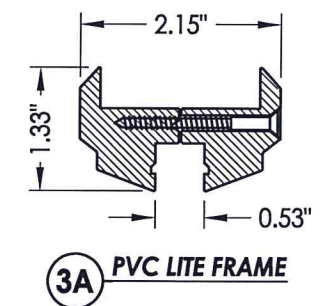

HARDWARE TABLE	
MANUFACTURER	MODEL
KWIKSET	KNOB: SIGNATURE SERIES DEADBOLT: SIGNATURE SERIES (980)

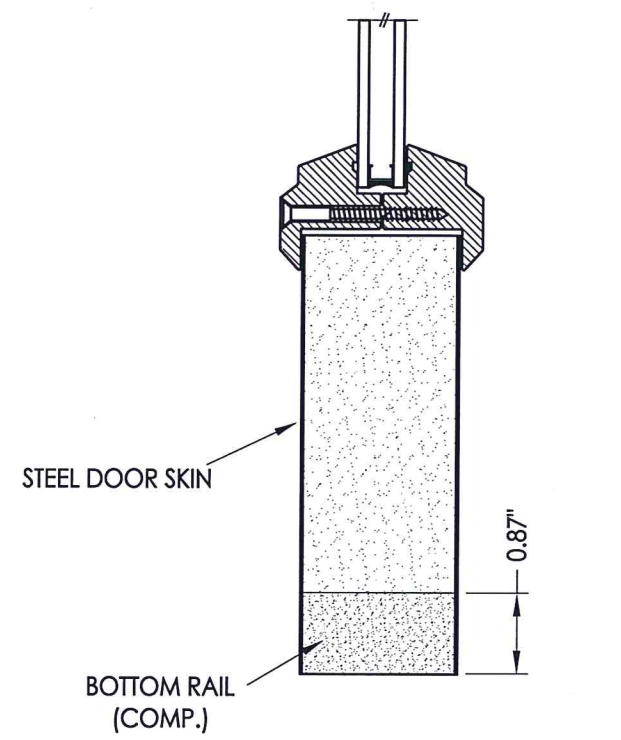
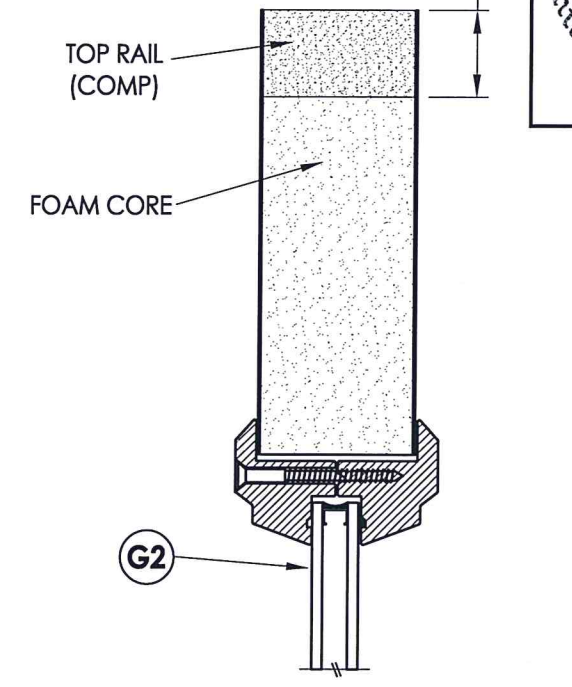

2 VERTICAL CROSS SECTION

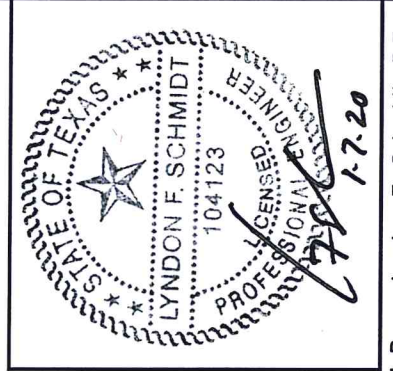

Documents Prepared By: Lyndon F. Schmidt, P.E.  
TEXAS P.E. #104123

**RW** BUILDING CONSULTANTS, INC.  
P.O. Box 230 Valrico FL 33595  
Phone No.: 813.659.9197

TEXAS BOARD OF PROFESSIONAL ENGINEERS  
CERTIFICATE OF REGISTRATION # F-11852

PRODUCT:	ENDURA	
PART OR ASSEMBLY:	DOOR PANEL DETAILS	
NO.	DATE	BY
1	1/06/20	LFS
ADD "FusionFrame" OPTION & UPDATE TO 2018 IBC/IRC CODE		
REVISIONS		
DATE: 12/11/17		
SCALE: N.T.S.		
DWG. BY: JK		
CHK. BY: LFS		
DRAWING NO.: TX-4775		
SHEET 2 OF 7		



R:\Clients\Endura PERMANENT\B - Texas Dept of Ins\TDI - DR-957 Glazed Thermo-Tru FG door OXO (LK, DB) 36 in SL (4775-4776)\C - Drawings\TX-4775.76.dwg, 3.3

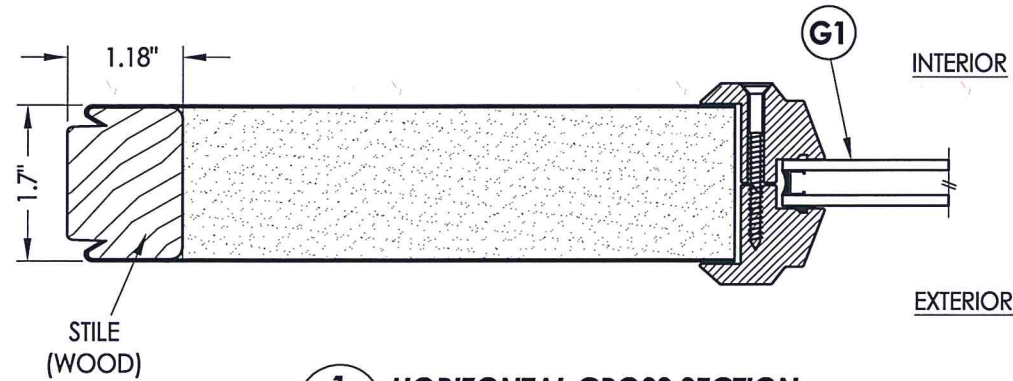

**1**  
**3** HORIZONTAL CROSS SECTION

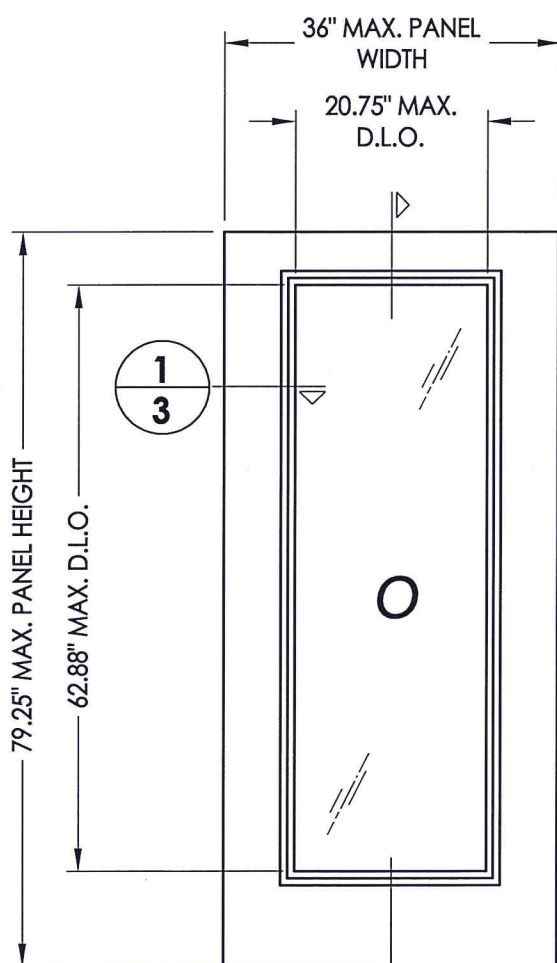

**2**  
**3**  
**50 SIDELITE PANEL**  
Therma-Tru Steel (Wood Edge)

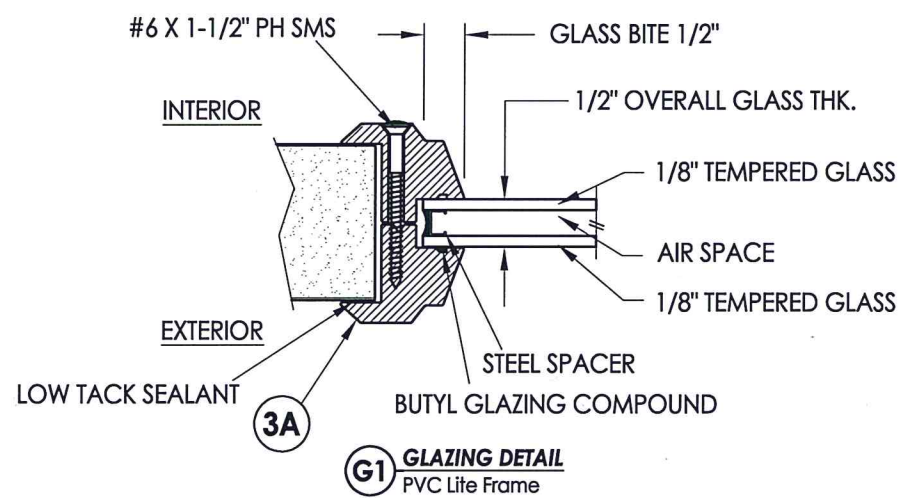

**G1 GLAZING DETAIL**  
PVC Lite Frame

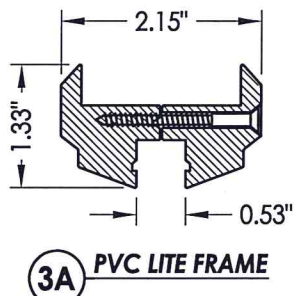

**3A PVC LITE FRAME**

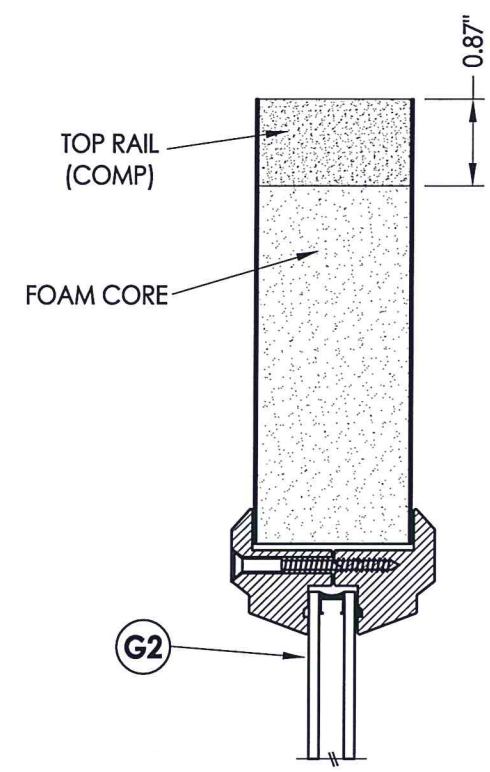

**G2**

INTERIOR EXTERIOR

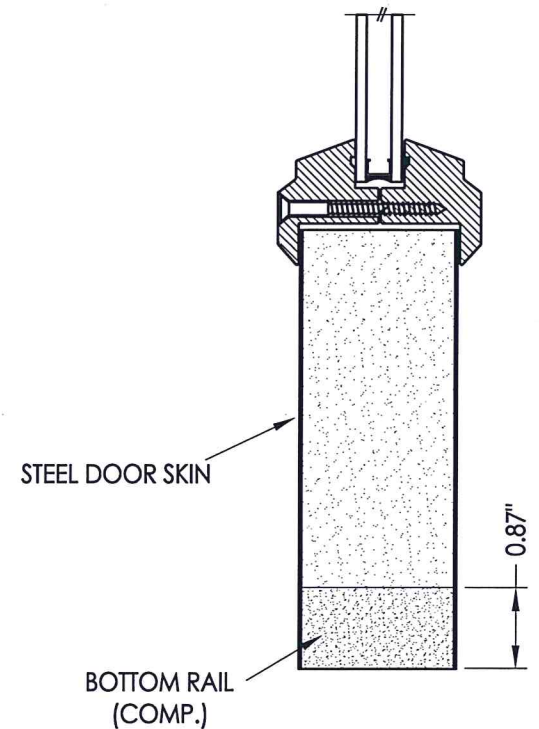

**2**  
**3** VERTICAL CROSS SECTION

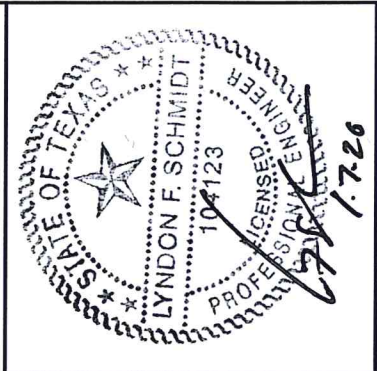

Documents Prepared By: Lyndon F. Schmidt, P.E.  
TEXAS P.E. #104123

**RW** BUILDING CONSULTANTS, INC.  
P.O. Box 230 Valrico FL 33595  
Phone No.: 813.659.9197

TEXAS BOARD OF PROFESSIONAL ENGINEERS  
CERTIFICATE OF REGISTRATION # F-11852

PRODUCT: ENDURA

PART OR ASSEMBLY: SIDELITE PANEL DETAILS

NO.	DATE	REVISIONS	BY
1	1/06/20	ADD "FusionFrame" OPTION & UPDATE TO 2018 IBC/IRC CODE	LFS

DATE: 12/11/17  
SCALE: N.T.S.  
DWG. BY: JK  
CHK. BY: LFS  
DRAWING NO.: TX-4775  
SHEET 3 OF 7

SIDLITE SKIN: STEEL 25 GA. (0.020" MIN. THICKNESS)  
CORE MATERIAL: POLYURETHANE FOAM



R:\Clients\Endura PERMANENT\B - Texas Dept of Ins\TDI - DR-957 Glazed Thermo-Tru FG door OXO (LK, DB) 36 in SL (4775-4776)\C - Drawings\TX-4775.76.dwg, 4.3

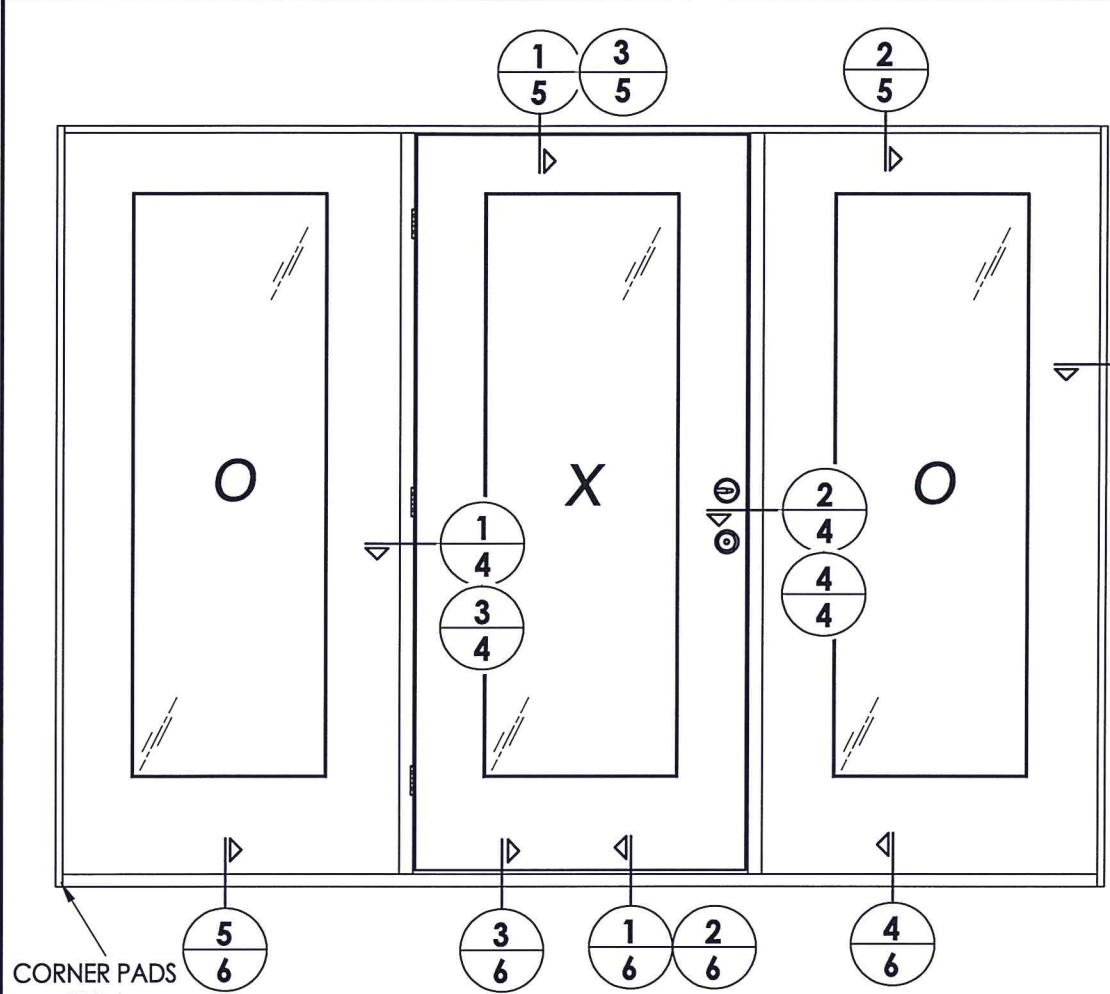

ELEVATION  
OXO SHOWN  
(XO/OX SIMILAR)

CORNER PADS  
(TYP.)

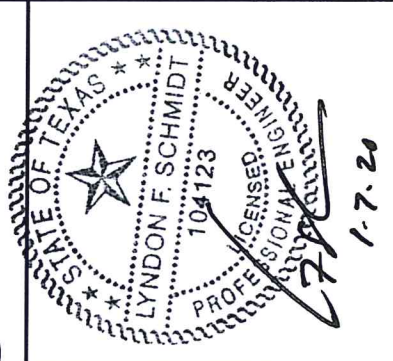

Documents Prepared By: Lyndon F. Schmidt, P.E.  
TEXAS P.E. #104123

**RW** BUILDING CONSULTANTS, INC.  
P.O. Box 230 Vairico FL, 33595  
Phone No.: 813.659.9197

TEXAS BOARD OF PROFESSIONAL ENGINEERS  
CERTIFICATE OF REGISTRATION # F-11852

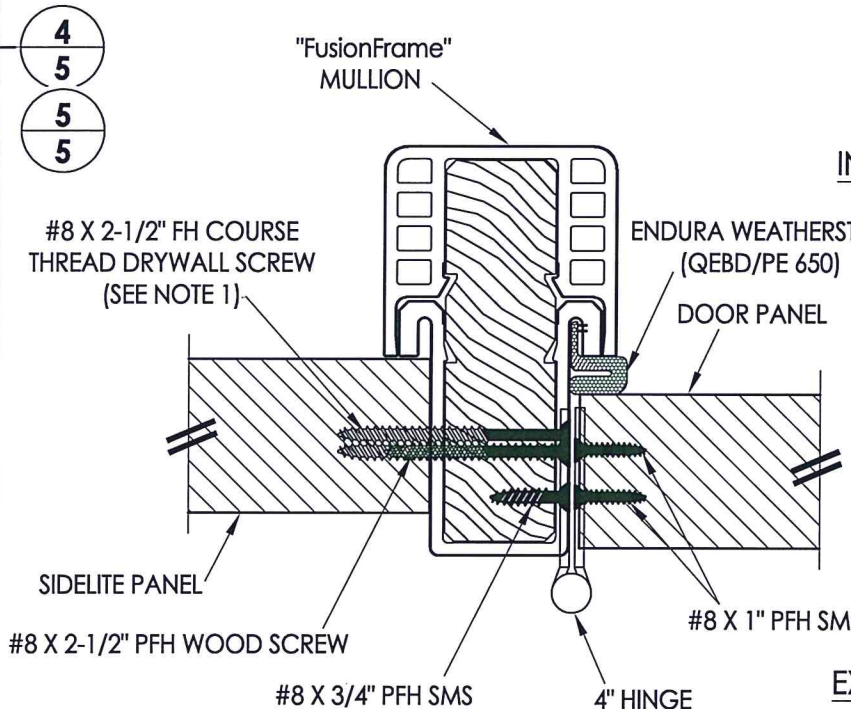

**3** HORIZONTAL CROSS SECTION  
Outswing shown - Inswing also approved

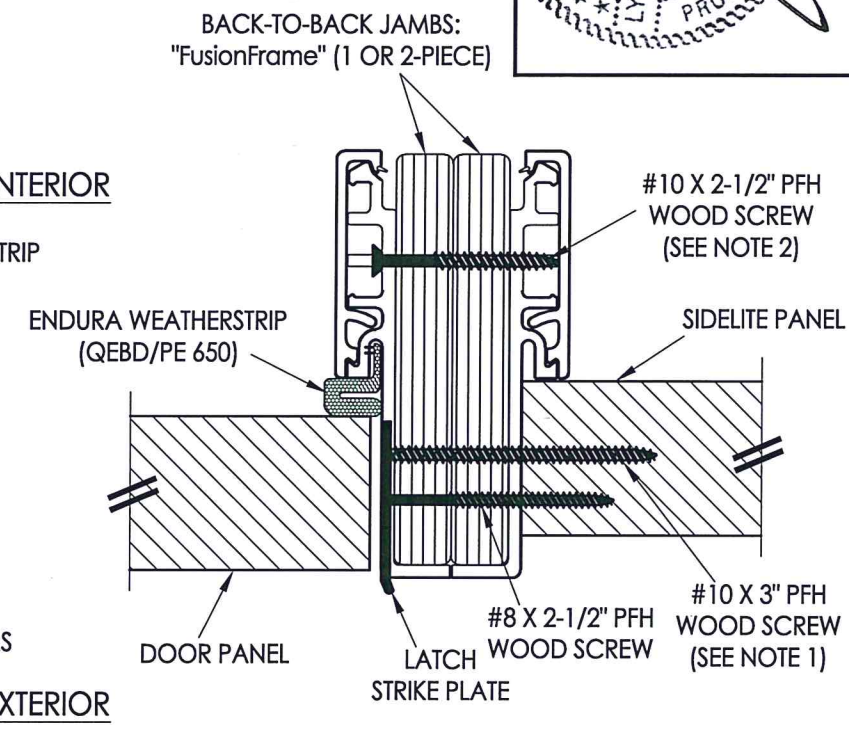

**4** HORIZONTAL CROSS SECTION  
Outswing shown - Inswing also approved

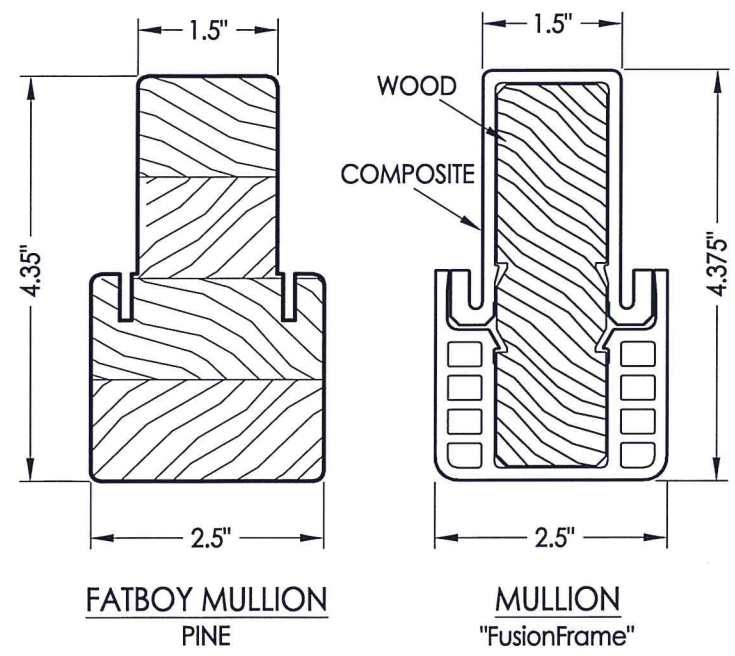

- NOTES:
1. Spacing for sidelite screws: 6.5", 38.5" and 69" from head to sill (3 total).
  2. Spacing for mullion screws: 6" from each end plus 3 more equally spaced (5 total).

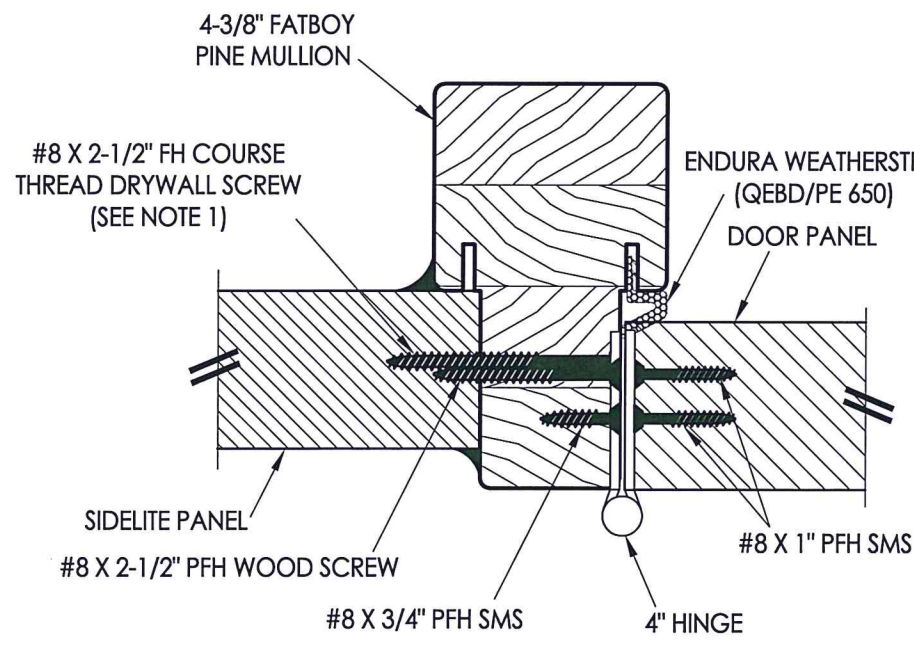

**1** HORIZONTAL CROSS SECTION  
Outswing shown - Inswing also approved

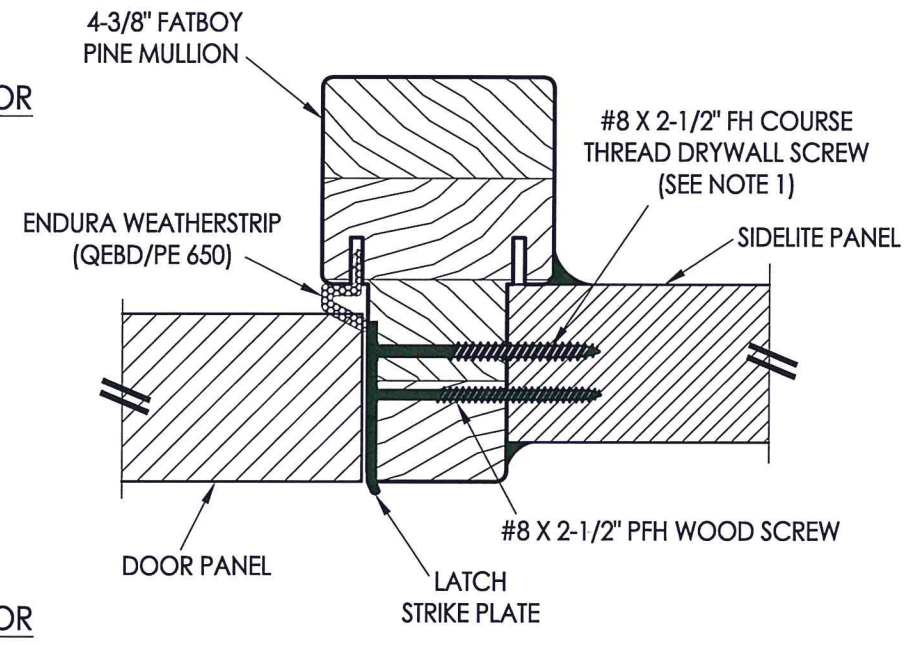

**2** HORIZONTAL CROSS SECTION  
Outswing shown - Inswing also approved

PRODUCT:	ENDURA
PART OR ASSEMBLY:	FIBERGLASS DOOR
DATE:	12/11/17
SCALE:	N.T.S.
DWG. BY:	JK
CHK. BY:	LFS
DRAWING NO.:	TX-4775
SHEET	4 OF 7
REVISIONS	BY
NO.	DATE
1	1/06/20
ADD "FusionFrame" OPTION & UPDATE TO 2018 IBC/IRC CODE	
LFS	BY



R:\Clients\Endura Permanent\B - Texas Dept of Ins\TDI - DR-957 Glazed Therma-Tru FG door OXO (LK, DB) 36 in SL (4775-4776)\C - Drawings\TX-4775.76.dwg, 5.3

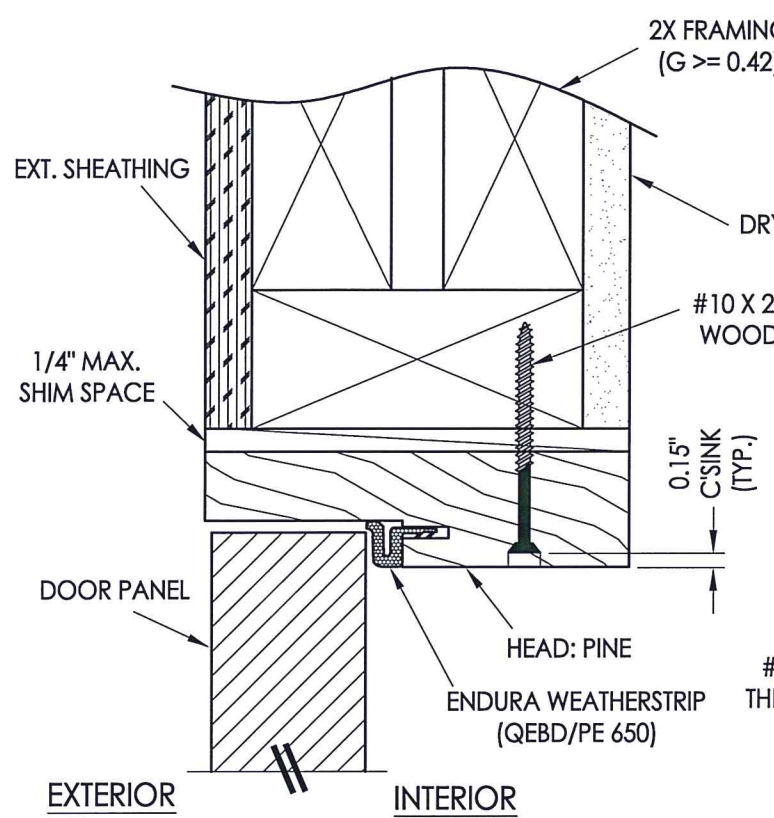

**1** VERTICAL CROSS SECTION  
**5** Outswing shown - inswing also approved

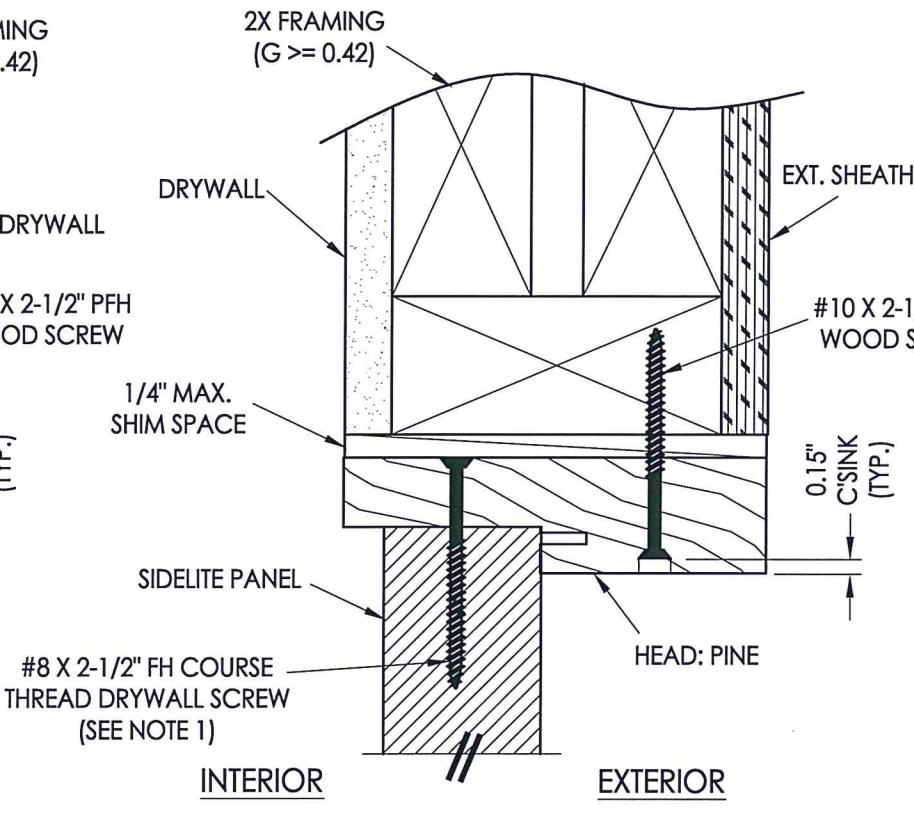

**2** VERTICAL CROSS SECTION  
**5** Inswing shown - Outswing also approved

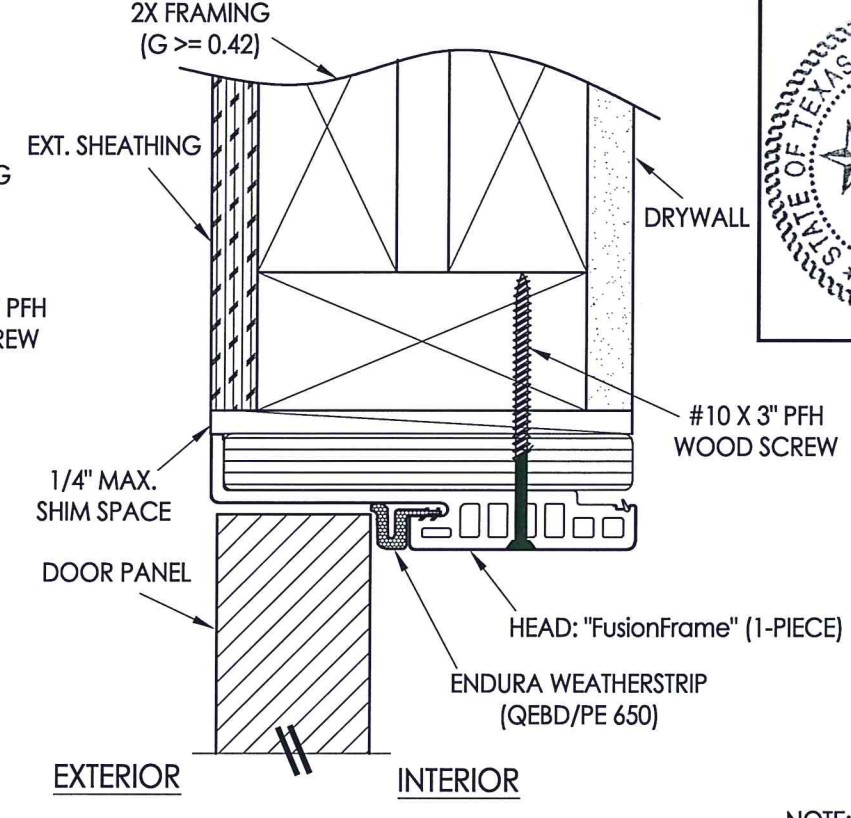

**3** VERTICAL CROSS SECTION  
**5** Outswing shown - inswing also approved

**NOTE:**  
 1. Spacing for sidelite screws: 4" from each end (2 total).

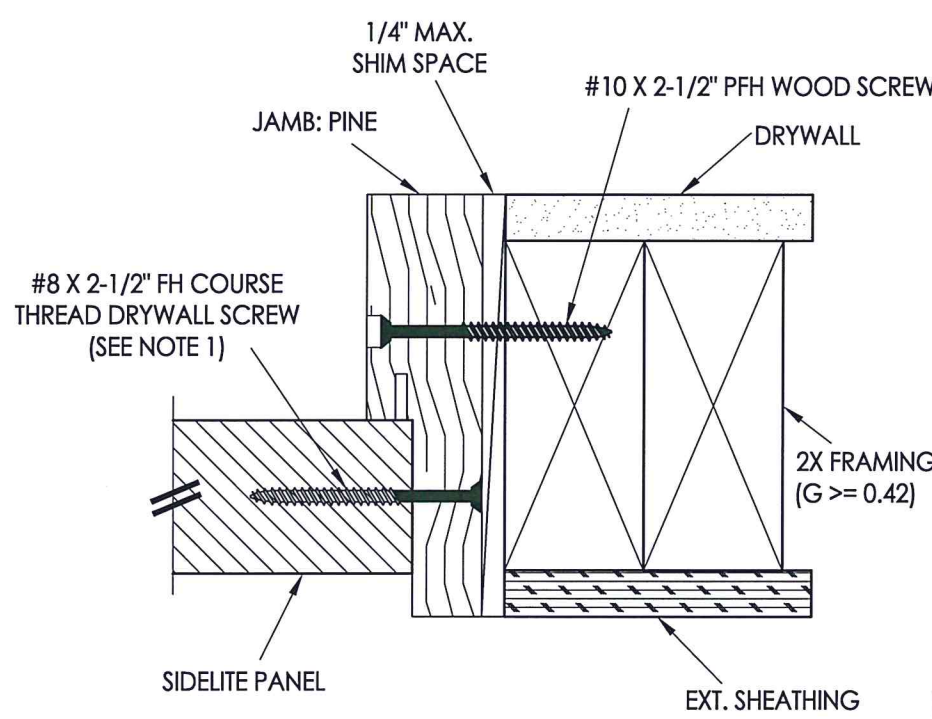
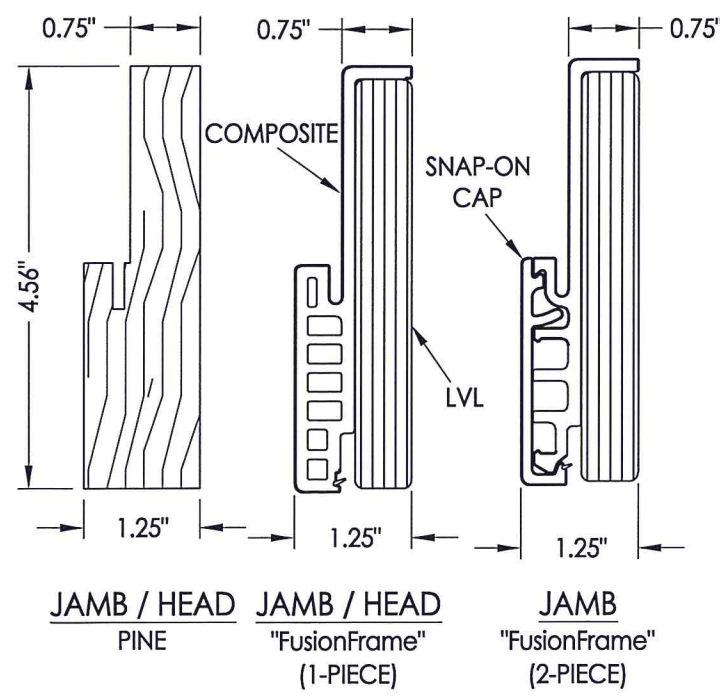

**4** HORIZONTAL CROSS SECTION  
**5** Outswing shown - Inswing also approved

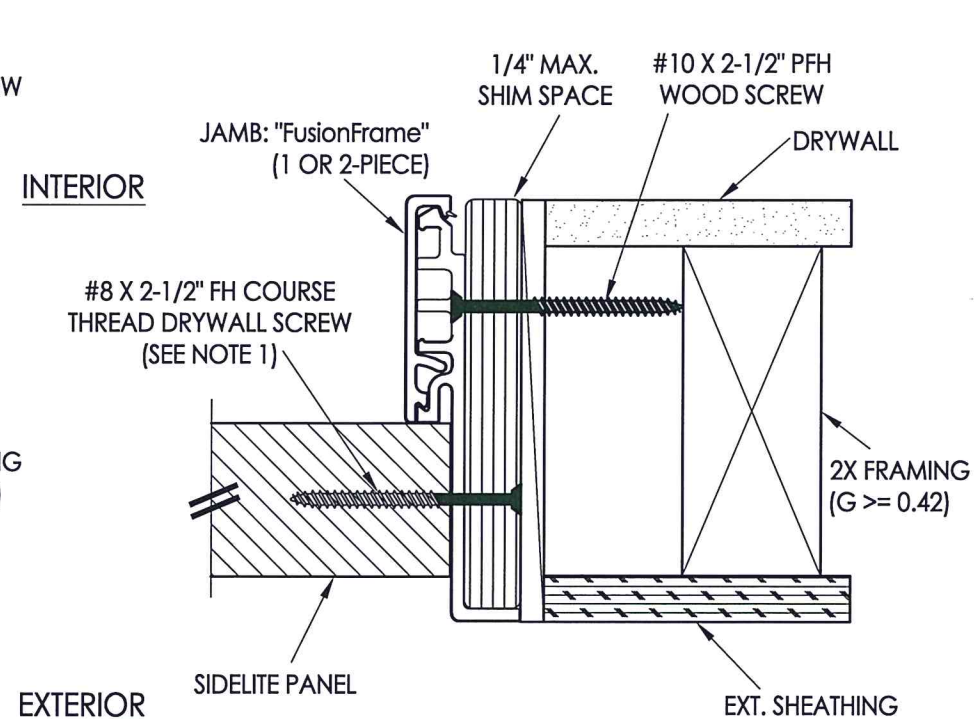

**5** HORIZONTAL CROSS SECTION  
**5** Outswing shown - Inswing also approved

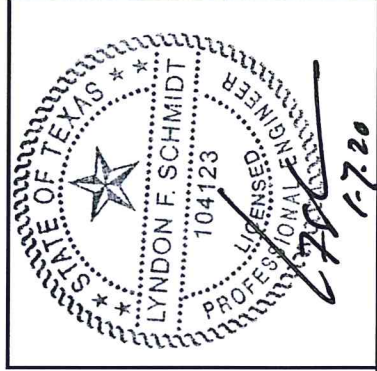

Documents Prepared By: Lyndon F. Schmidt, P.E.  
 TEXAS P.E. #104123

**RW** BUILDING CONSULTANTS, INC.  
 P.O. Box 230 Valrico FL 33595  
 Phone No.: 813.659.9197

TEXAS BOARD OF PROFESSIONAL ENGINEERS  
 CERTIFICATE OF REGISTRATION # F-11852

PRODUCT:	ENDURA
PART OR ASSEMBLY:	VERTICAL & HORIZONTAL CROSS SECTIONS

NO.	DATE	BY	REVISIONS
1	1/06/20	LFS	ADD "FusionFrame" OPTION & UPDATE TO 2018 IBC/IRC CODE

DATE:	12/11/17
SCALE:	N.T.S.
DWG. BY:	JK
CHK. BY:	LFS
DRAWING NO.:	TX-4775
SHEET	5 OF 7



R:\Clients\Endura PERMANENT\B - Texas Dept of Ins\TDI - DR-957 Glazed Thermo-Tru FG door OXO (LK, DB) 36 in SL (4775-4776)C - Drawings\TX-4775.76.dwg, 6.3

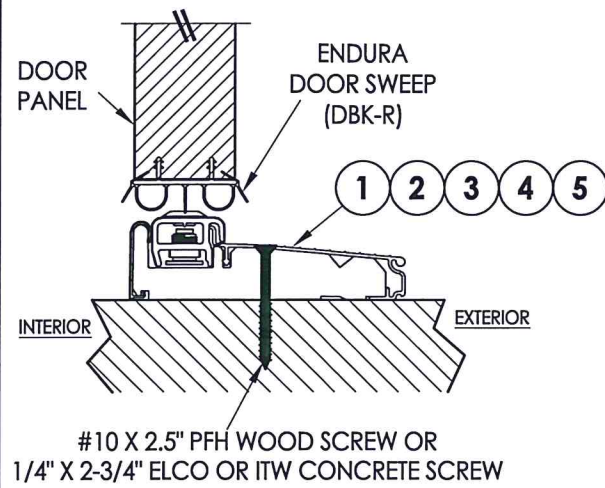

**1** VERTICAL CROSS SECTION  
**6** Inswing Adjustable Threshold

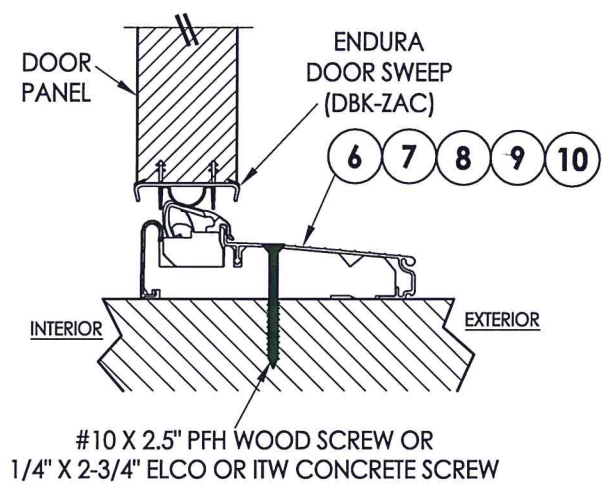

**2** VERTICAL CROSS SECTION  
**6** Inswing Articulating Threshold

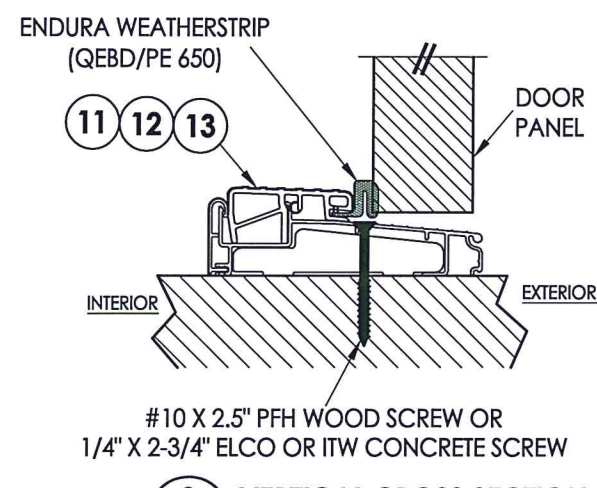

**3** VERTICAL CROSS SECTION  
**6** Outswing Bump Threshold

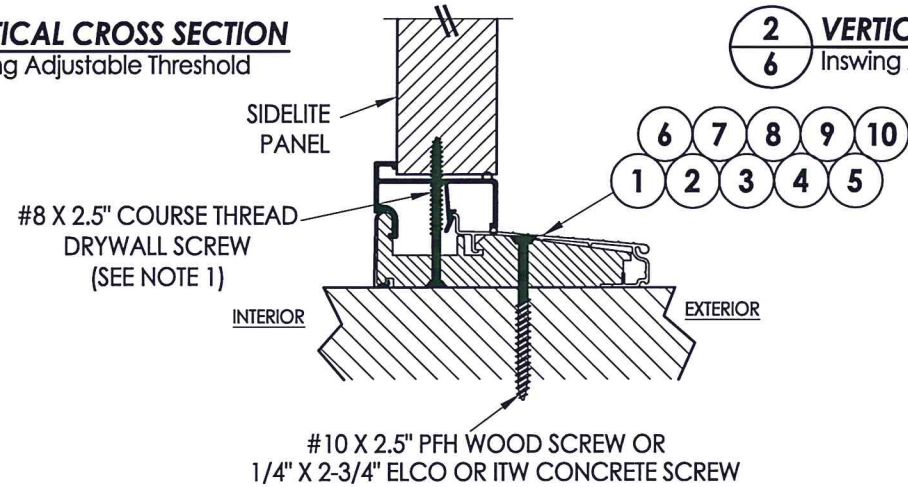

**4** VERTICAL CROSS SECTION  
**6** Inswing configuration

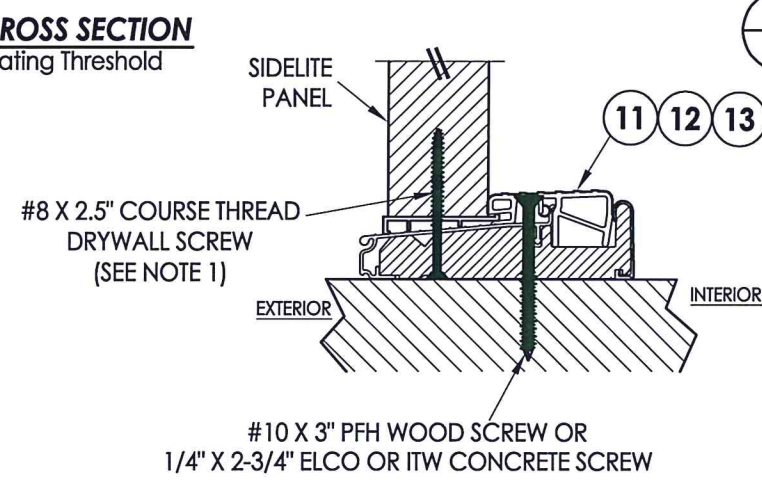

**5** VERTICAL CROSS SECTION  
**6** Outswing configuration

NOTE:  
1. Spacing for sidelite screws:  
6\"/>



Documents Prepared By: Lyndon F. Schmidt, P.E.  
TEXAS P.E. #104123

**RW** BUILDING CONSULTANTS, INC.  
P.O. Box 230 Valrico FL, 33595  
Phone No.: 813.659.9197

TEXAS BOARD OF PROFESSIONAL ENGINEERS  
CERTIFICATE OF REGISTRATION # F-11852

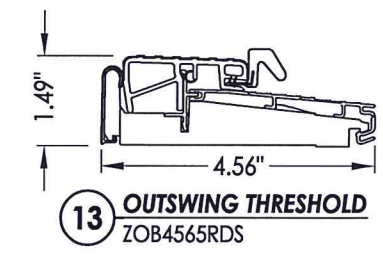
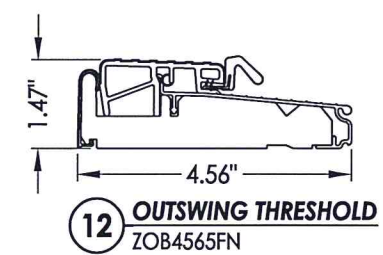
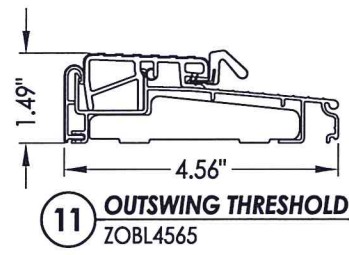
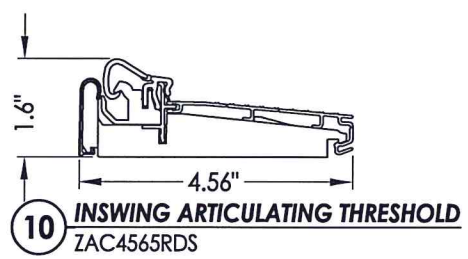
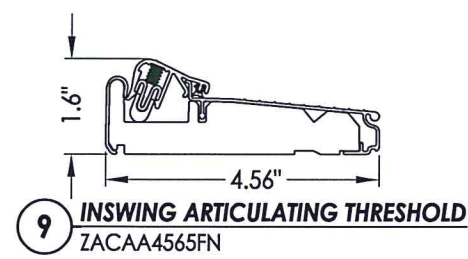
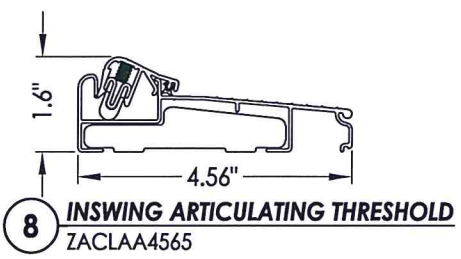
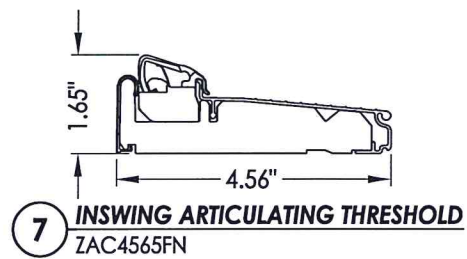
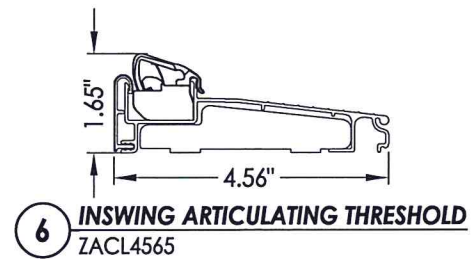
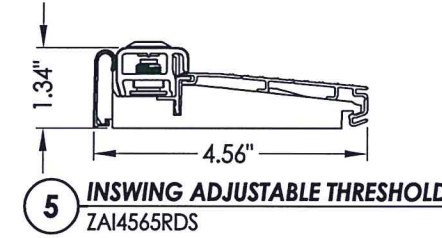
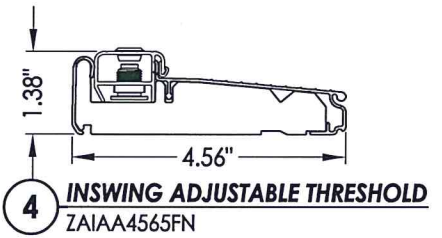
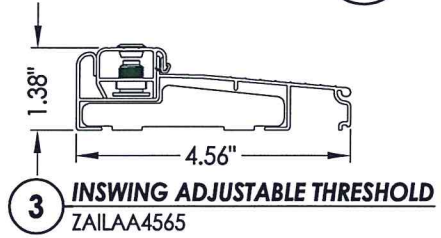
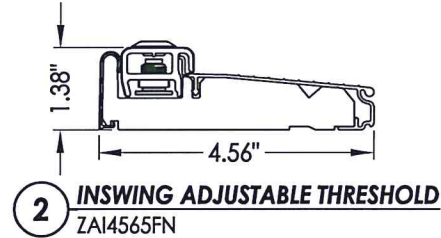
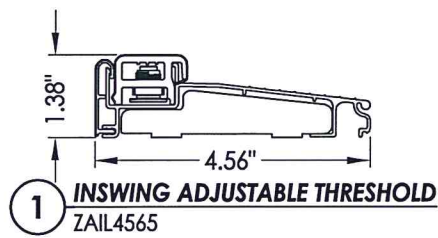

PRODUCT:		ENDURA	
PART OR ASSEMBLY:		FIBERGLASS DOOR	
REVISIONS		NO.	DATE
1	1/06/20	ADD "FusionFrame" OPTION & UPDATE TO 2018 IBC/IRC CODE	LFS
DATE:		12/11/17	
SCALE:		N.T.S.	
DWG. BY:		JK	
CHK. BY:		LFS	
DRAWING NO.:		TX-4775	
SHEET		6 OF 7	

© 2017 R.W. BUILDING CONSULTANTS INC.



R:\Clients\Endura PERMANENT\B - Texas Dept of Ins\TDI - DR-957 Glazed Thermo-Tru FG door OXO (LK, DB) 36 in SL (4775-4776)\C - Drawings\TX-4775.76.dwg, 7.3

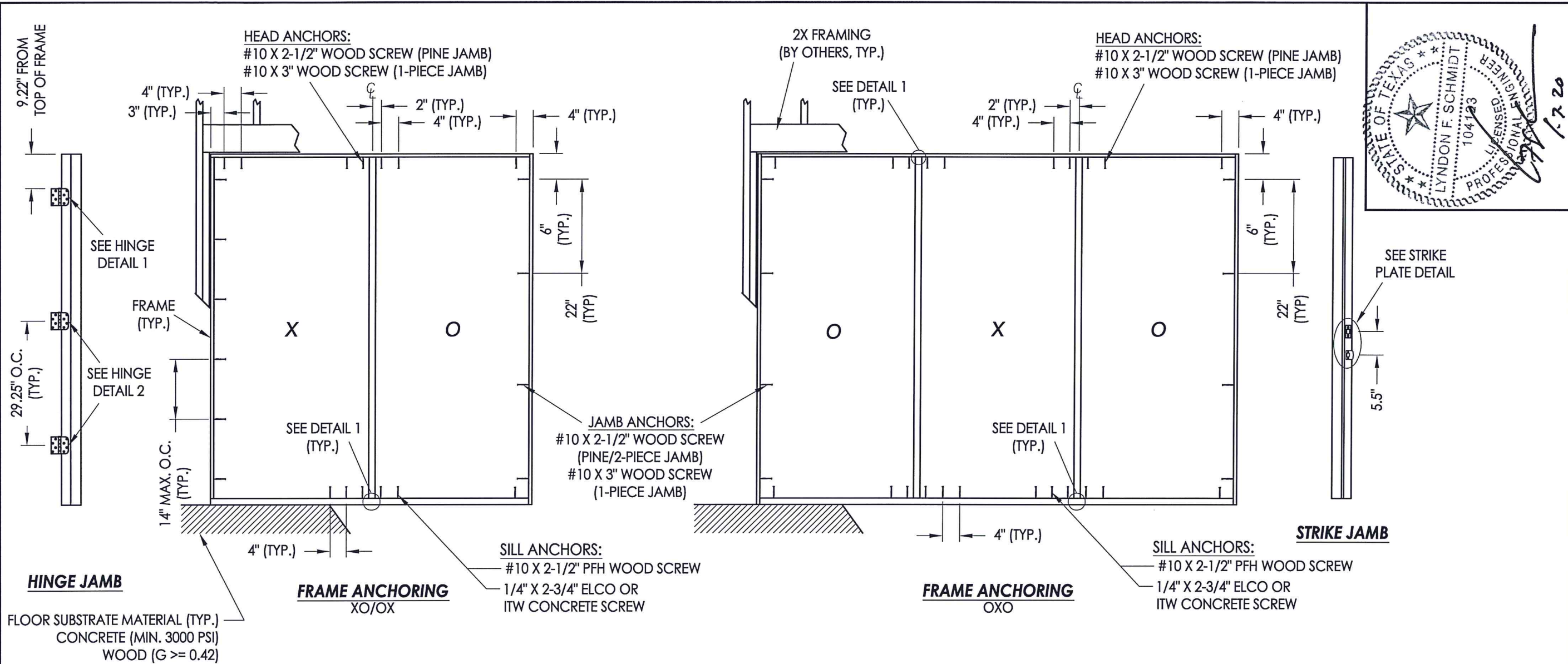

**JAMB NOTES:**  
 THE PINE OR "FusionFrame" 1-PIECE JAMB MAY BE INSTALLED @ THE HEAD OR SIDE JAMB.  
 THE FusionFrame" 2-PIECE JAMB MAY BE INSTALLED @ THE SIDE JAMBS ONLY.

**INTEGRAL MULLION NOTES:**  
 THE FATBOY PINE MULLION, "FusionFrame" MULLION, OR THE "FusionFrame" BACK-TO-BACK JAMB (1-PIECE OR 2-PIECE) MAY ALL BE USED AS THE INTEGRAL MULLION.

- CONCRETE ANCHOR NOTES:**
- Concrete anchor locations at the corners may be adjusted to maintain the min. edge distance to mortar joints.
  - Concrete anchor locations noted as "MAX. ON CENTER" must be adjusted to maintain the min. edge distance to mortar joints, additional concrete anchors may be required to ensure the "MAX. ON CENTER" dimension are not exceeded.
  - Concrete anchor table:

ANCHOR TYPE	ANCHOR SIZE	MIN. EMBEDMENT	MIN. CLEARANCE TO MASONRY EDGE	MIN. CLEARANCE TO ADJACENT ANCHOR
ITW TAPCON®	1/4"	1-3/4"	1-1/2"	4"
ELCO ULTRACON®	1/4"	1-3/4"	1"	4"

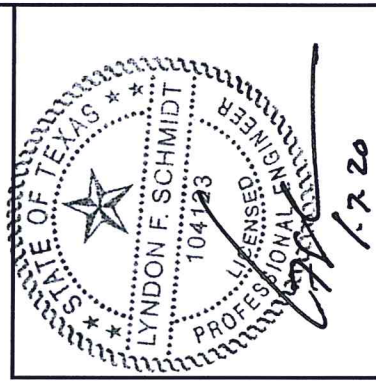
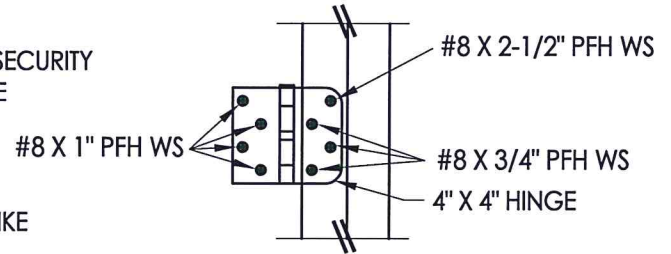
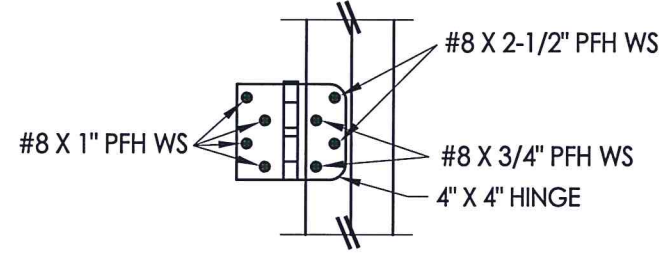
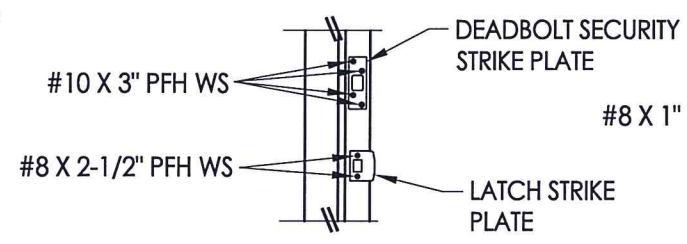
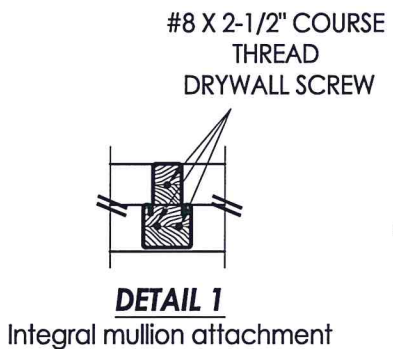

Documents Prepared By: Lyndon F. Schmidt, P.E.  
 TEXAS P.E. #104123

**RW** BUILDING CONSULTANTS, INC.  
 P.O. Box 230 Valrico FL, 33595  
 Phone No.: 813.659.9197

TEXAS BOARD OF PROFESSIONAL ENGINEERS  
 CERTIFICATE OF REGISTRATION # F-11852

PRODUCT:	ENDURA	
PART OR ASSEMBLY:	FRAME ANCHORING	
NO.	DATE	BY
1	1/06/20	LFS
ADD "FusionFrame" OPTION & UPDATE TO 2018 IBC/IRC CODE		
REVISIONS		
DATE:	12/11/17	
SCALE:	N.T.S.	
DWG. BY:	JK	
CHK. BY:	LFS	
DRAWING NO.:	TX-4775	
SHEET	7 OF 7	

© 2017 R.W. BUILDING CONSULTANTS INC.